

GENERAL NOTES

- ALL UTILITY WORK SHALL CONFORM WITH THE "NEW MEXICO STANDARD SPECIFICATIONS FOR PUBLIC WORKS CONSTRUCTION, 1997 EDITION", AND ALL SUBSEQUENT AMENDMENTS AND PROVISIONS UNLESS OTHERWISE INDICATED IN WRITING BY THE ENGINEER. ALL SITE WORK SHALL BE PERFORMED IN ACCORDANCE WITH THE NEW MEXICO STATE HIGHWAY AND BRIDGE CONSTRUCTION, 2000 EDITION" OR LATER EDITION. ALL WORK SHALL CONFORM TO THE NM STANDARD SPECIFICATIONS FOR PUBLIC WORKS CONSTRUCTION.
- THE CONTRACTOR SHALL NOTIFY THE COUNTY, PUBLIC WORKS DEPARTMENT OF THE PROPOSED COMMENCEMENT OF CONSTRUCTION AND PROPOSED WORK SCHEDULE AT LEAST 24 HOURS PRIOR TO THE ACTUAL COMMENCEMENT OF CONSTRUCTION. A COPY OF THE APPROVED PLANS SHALL BE AVAILABLE AT THE CONSTRUCTION SITE AT ALL TIMES DURING WORKING HOURS.
- THE OWNER SHALL BE RESPONSIBLE, THROUGH HIS ENGINEER, FOR MAKING ALL ENGINEERING PLAN CHANGES AND REVISIONS TO THE ORIGINAL APPROVED ENGINEERING DRAWINGS. ALL CHANGES SHALL BE APPROVED BY THE COUNTY PRIOR TO CONSTRUCTION. RECORD DRAWINGS SHALL BE FILED WITH THE COUNTY BEFORE PROJECT ACCEPTANCE.
- PARALLEL WATER AND SEWER LINES SHALL BE AT LEAST TEN FEET APART. WATER AND SEWER LINES SHALL BE AT LEAST TEN FEET FROM ANY EXISTING UTILITY. WHEN WATER AND SEWER LINES CROSS EACH OTHER, THE WATER LINE SHALL BE AT LEAST 18 INCHES ABOVE THE SEWER LINE. OTHERWISE THE SEWER SHALL BE OF PRESSURE GLASS PIPE EXTENDING BETWEEN MANHOLES OR CONCRETE ENCASED FOR TEN FEET ON EACH SIDE OF THE WATER LINE.
- THE CONTRACTOR MUST OBTAIN ALL SEWER HOOKUP PERMITS BEFORE COMMENCING ANY SEWER LINE CONSTRUCTION WITHIN THE COUNTY RIGHT-OF-WAY. A COPY OF THE PERMIT MUST BE AT THE CONSTRUCTION SITE TO BE SHOWN TO THE COUNTY INSPECTOR UPON REQUEST.
- THE CONTRACTOR SHALL BE RESPONSIBLE FOR THE LOCATION OF ALL EXISTING UTILITIES AND SHOULD NOT RELY SOLELY ON THESE PLANS FOR EXISTING UTILITY LOCATIONS.
- THE CONTRACTOR SHALL PROVIDE AN AREA TO STORE CONSTRUCTION DEBRIS WHERE IT WILL NOT BE A NUISANCE TO THE SURROUNDING NEIGHBORHOOD. ALL DEBRIS SHALL BE CONTAINED IN SUCH A MANNER THAT IT WILL NOT BE A NUISANCE TO THE SURROUNDING NEIGHBORHOOD. UNDERGROUND UTILITY LINES SHALL BE PROTECTED BY A 12" MINIMUM THICKNESS OF CONCRETE OR OTHER APPROVED MATERIALS. ALL DEBRIS SHALL BE REMOVED FROM THE SITE PRIOR TO FINAL SITE INSPECTION.
- THE CONTRACTOR SHALL CONFINER HIS OPERATIONS TO THE CONSTRUCTION LIMITS OF THE PROJECT AND IN NO WAY SHALL ENCROACHMENT OCCUR ONTO ADJACENT PROPERTIES UNLESS LEGAL EASEMENTS ARE OBTAINED. ALL FILL AND CUT SLOPES SHALL BE SETBACK FROM THE PROPERTY LINE IN ACCORDANCE WITH CHAPTER 70 OF THE NEW MEXICO BUILDING CODE. THE CONTRACTOR SHALL BE RESPONSIBLE FOR OBTAINING ANY AGREEMENTS NECESSARY OR DAMAGE CAUSED BY CONSTRUCTION ACTIVITIES TO PUBLIC OR PRIVATE PROPERTY INCLUDING UTILITIES.
- ALL CHANGE ORDERS SHALL BE CENTERED BY A NEW MEXICO PROFESSIONAL ENGINEER. THE CONTRACTOR SHALL BE RESPONSIBLE FOR OBTAINING ALL NECESSARY PERMITS AND APPROVAL PRIOR TO IMPLEMENTING CHANGE ORDER CONSTRUCTION.
- FOR ALL CONCRETE USED, THE DESIGN COMPRESSIVE STRENGTH AT 28 DAYS SHALL BE 3000 PSI, 6 BAG MIX AND MAXIMUM AGGREGATE SIZE OF 3/4 INCH. PERCENTAGE OF AIR ENTRAINMENT IN THE CONCRETE AT THE PROJECT SITE SHALL BE IN THE RANGE OF 4 TO 7 PERCENT.
- ONE SET OF CONCRETE SAMPLES (THREE CONCRETE CYLINDERS) TO BE TAKEN FOR EACH 1000 CYCLES OF CONCRETE. CONCRETE CYLINDERS OR A MINIMUM OF ONE SAMPLE PER DAY WHICH EVER IS THE GREATTEST. CONCRETE CYLINDERS ARE TO BE TEST BROKEN AT 7-DAY, 28-DAY AND 45-DAY (IF NEEDED) INTERVALS WITH TEST RESULTS SUBMITTED DIRECTLY TO THE ENGINEER.
- THE DEVELOPER/CONTRACTOR DURING CONSTRUCTION SHALL MAINTAIN THE PROPER TRAFFIC CONTROL DEVICES IN COMPLIANCE WITH THE MANUAL ON UNIFORM TRAFFIC CONTROL DEVICES AND AS APPROVED BY THE COUNTY.
- THE MAXIMUM DEVIATION OF THE TOP SURFACE OF THE CURB AND GUTTER SHALL NOT EXCEED 1/8 INCH IN 10 FEET NOR SHALL THE INSIDE FACE DEVIATE MORE THAN 1/4 INCH IN 10 FEET FROM A STRAIGHT LINE. ALL AREAS WITH STANDING WATER SHALL BE REJECTED.
- THE CONTRACTOR SHALL IMPLEMENT THE NECESSARY SITE EROSION CONTROL DEVICES FOR INHIBITING DUST, WIND AND AIR SEDIMENT MOVEMENT OFFSITE DURING ALL PHASES OR STAGES OF CONSTRUCTION.
- UTILITY LINES MUST BE BORED UNDER ALL EXISTING STREET CONCRETE APPURTENANCES. A MINIMUM OF 12 INCHES OF SEPARATION MUST BE MAINTAINED BETWEEN UTILITY LINES. ALL CURB AND GUTTER DAMAGE MUST BE REPAIRED BEFORE FINAL INSPECTION.
- SUBGRADE BASE MATERIAL, ASPHALT TREATED BASE AND ASPHALT SURFACE COURSE REQUIRE COMPACTION TESTS FOR EACH 220 LINEAR FEET OF TRENCHING, AND 30 SQUARE YARDS OF EXTERIOR PAVING/CONCRETE WALK SUBBASE. ASPHALT SAMPLES FOR EACH 500 TONS INSTALLED OR ONE SAMPLE PER DAY IS REQUIRED TO BE ANALYZED WITH TEST RESULTS SUBMITTED TO THE ENGINEER. ALL SUBGRADE AND ASPHALT TREATED BASE ARCHITECTURAL SPECIFICATIONS.
- ALL UTILITY APPURTENANCES SUCH AS TELEPHONE PEDESTALS, ELECTRICAL BOXES, GAS AND CABLE TELEVISION, SHALL BE FLAGGED WITH RED AND WHITE PLYWOOD PANELS. THE CONTRACTOR SHALL BE RESPONSIBLE FOR THE RELOCATION OF MISLOCATED UTILITY STRUCTURES PRIOR TO PROJECT ACCEPTANCE.
- CONTRACTOR SHALL FOLLOW ALL RECOMMENDATIONS MADE WITHIN GEOTECHNICAL REPORT.
- ALL TURNOUT LOCATIONS SHALL BE APPROVED BY THE TRAFFIC ENGINEER PRIOR TO CONSTRUCTION OF THE SAME.

GRADING AND DRAINAGE NOTES

- RADI AND NEZ COORDINATES ALONG CURB LINE ARE AT THE TOP BACK OF CURB, UNLESS OTHERWISE NOTED. (N = NORTHING, E= EASTING, AND Z= ELEVATION AS REFERENCED FROM BENCHMARK)
- CURBRAMPS SHALL MEET THE FOLLOWING CRITERIA: A) RAMP CLEAR WIDTHS OF 36" MIN., OR AS SHOWN B) MAXIMUM SLOPE OF 1:12 FOR RAMP AND 10:1 FLARED SIDE SLOPES C) PROVIDE TEXTURE BY HEAVY BROOMING TRANSVERSE TO RAMP (0.035" DEPTH) D) CONTRACTOR SHALL VERIFY COMPLIANCE WITH THE "ANSI: ACCESSIBLE AND USABLE BUILDINGS AND FACILITIES, 2003" 3. UNLESS SHOWN OTHERWISE, SLABS ADJACENT TO BUILDINGS SHALL BE .05' BELOW FINISH FLOOR, AND SLOPE AWAY.
- MAXIMUM CUT AND FILL SLOPES SHALL BE 2:1. STEEPER SLOPES SHALL REQUIRE 6" THICK, 4" MINUS RIPRAP PROTECTION.
- SUBGRADE MATERIALS (6" AGGREGATE BASE COURSE & 12" STABILIZED COMPACTED SUBGRADE) IN DETAILS ON THIS SHEET AND OTHER SHEETS ASSUMED. ALL SOILS (TYPE, THICKNESS, STABILIZATION AND COMPACTION) SHALL BE IN ACCORDANCE WITH THE GEOTECHNICAL SOILS REPORT.
- COORDINATES GIVEN AT CORNERS OF ALL BUILDINGS ARE APPROXIMATE. EXACT DIMENSIONS OF BUILDINGS PER ARCHITECT. ELEVATIONS AT THESE COORDINATES ARE GIVEN AT ADJACENT GRADES.
- ALL SITE CONSTRUCTION AND MATERIALS SHALL MEET OR EXCEED THE NM STANDARD SPECIFICATION FOR PUBLIC WORKS CONSTRUCTION, 2006 EDITION.
- CONTRACTOR SHALL PROVIDE A LANDING (SLOPING AWAY FROM BUILDING @ 2% MAX) AT THE EXTERIOR OF EACH BUILDING ENTRANCE. FOR OUTSWINGING DOORS, LANDING SHALL BE 60" SQUARE. FOR INSWINGING DOORS LANDING SHALL BE 48" SQUARE. ALIGN EDGE OF LANDING WITH BACK OF HINGED JAMB.
- LAYOUT OF CONTRACTION/EXPANSION JOINTS IN EXTERIOR WALKWAYS PER CONTRACTOR/ARCHITECT. CONTRACTION JOINTS SHALL BE 15' O.C. MAX. AND EXPANSION JOINTS SHALL BE 45' O.C. MAX. CONTRACTION/EXPANSION JOINTS IN CURB AND GUTTER PER PUBLIC WORKS STANDARDS.
- COORDINATES GIVEN AT MOST OR ALL KEY COORDINATES. CONTRACTOR MAY USE CONTOUR INFORMATION AND SCALING TO INTERPOLATE ANY ADDITIONAL ELEVATION INFORMATION.
- STORMWATER RETENTION POND SHALL BE LINED WITH 4" THICK, 4" MINUS COBBLE RIPRAP AND/OR LANDSCAPING ROCKS AND VEGETATION.

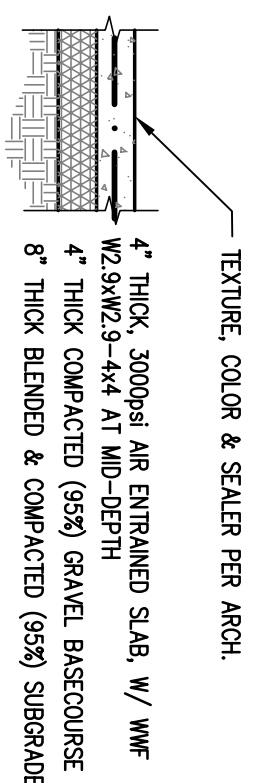

GRAVEL AND SUBGRADE (THICKNESS, TYPE & COMPACTION), ASSUMED. SEE GEOTECHNICAL REPORT FOR RECOMMENDATIONS.

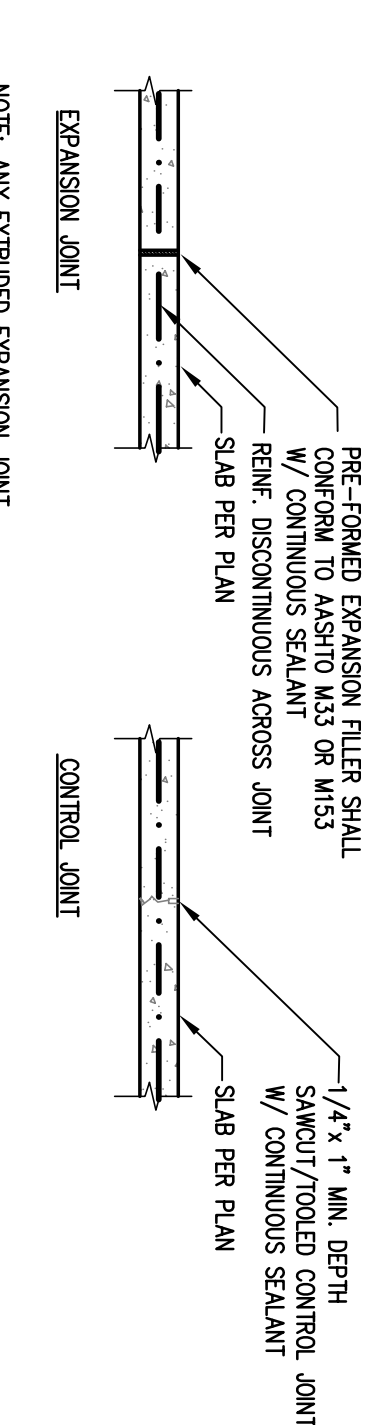
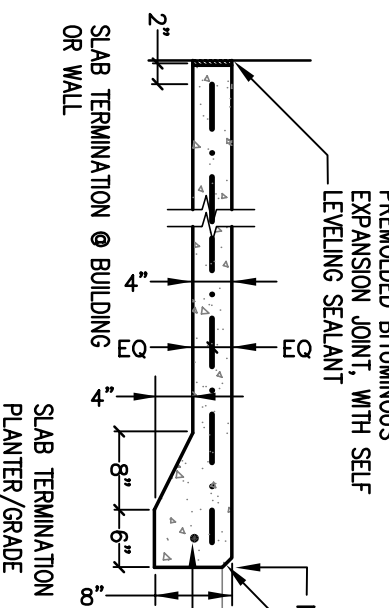

CONCRETE SIDEWALK DETAILS

N.T.S.

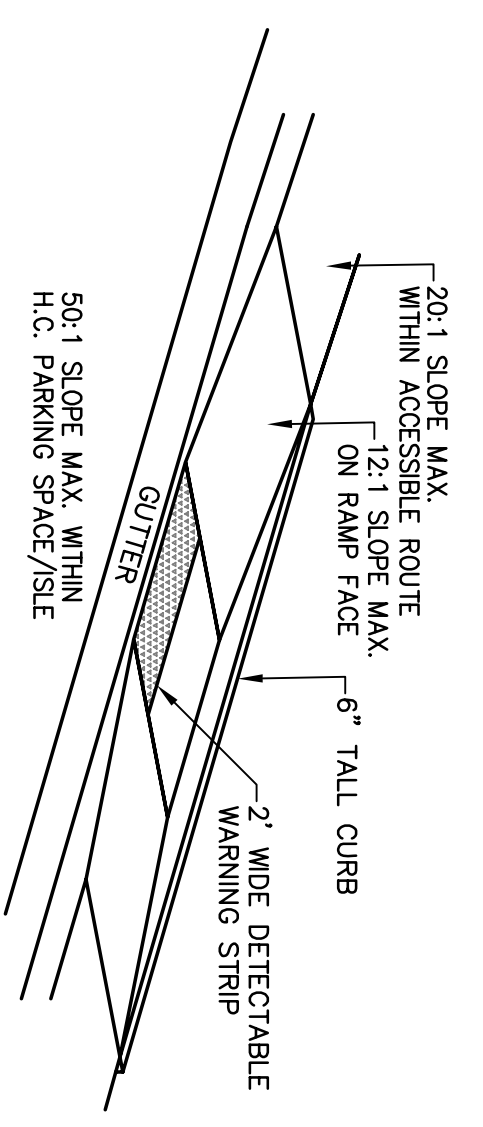

CURB RAMP DETAIL

N.T.S.

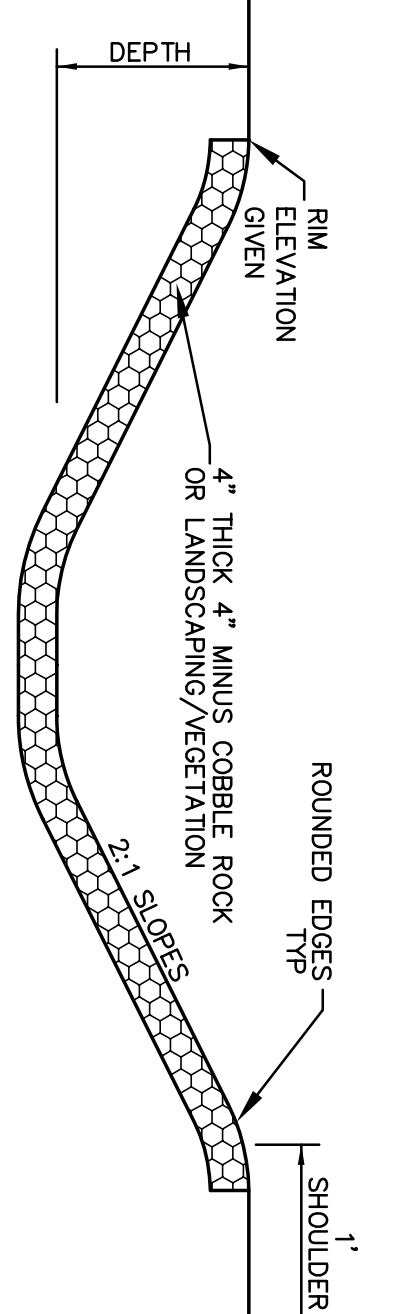

TYPICAL RETENTION POND DETAIL

N.T.S.

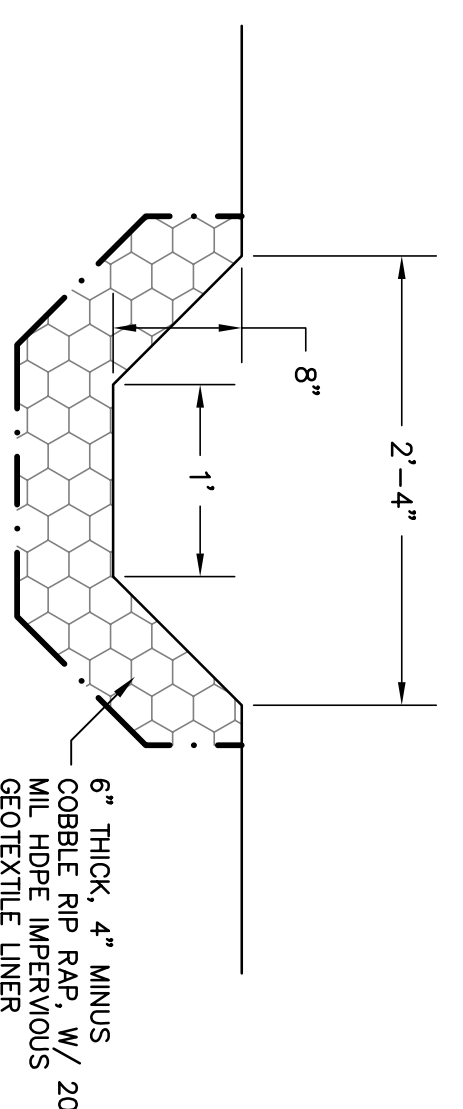

DRAINAGE CHANNEL

N.T.S.

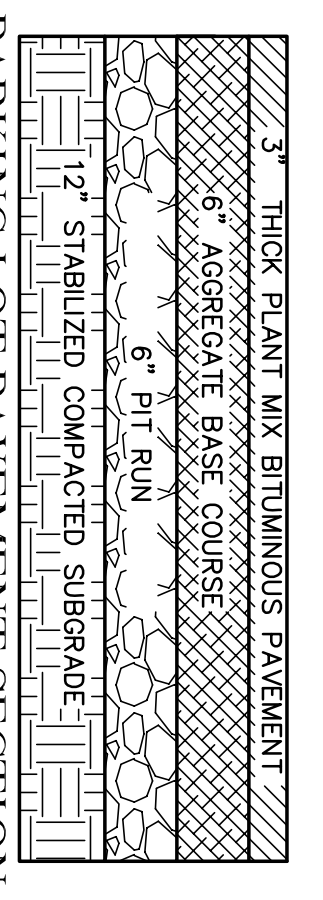

PARKING LOT PAVEMENT SECTION

N.T.S.

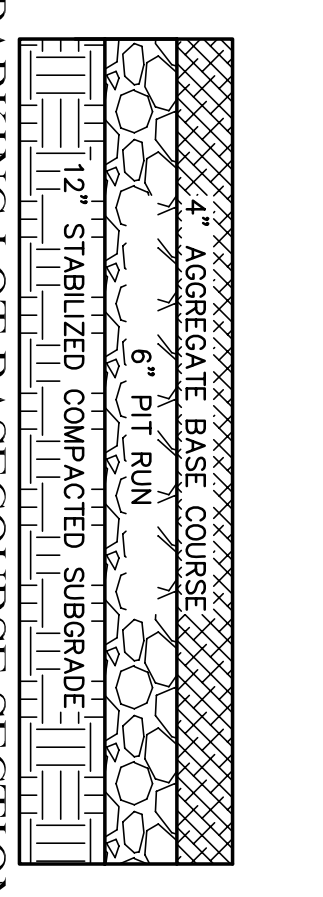

PARKING LOT BASECOURSE SECTION

N.T.S.

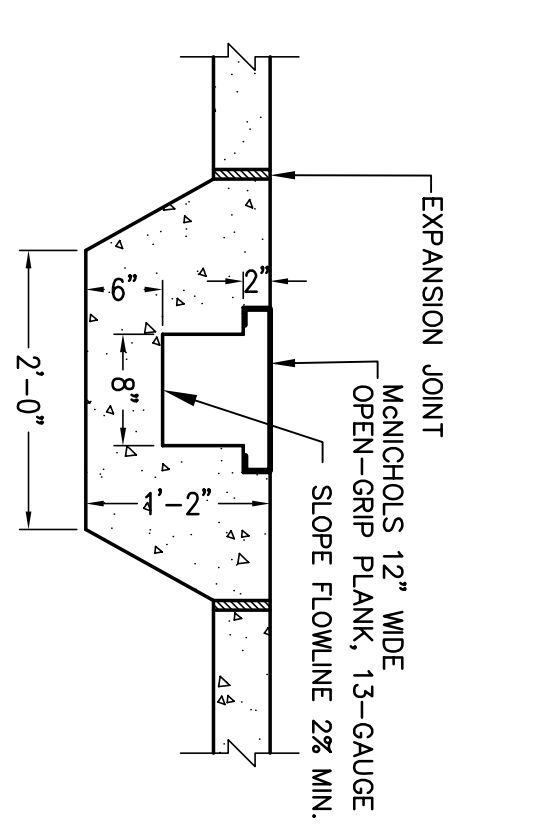

SIDEWALK TRENCH GRATE DRAIN

N.T.S.

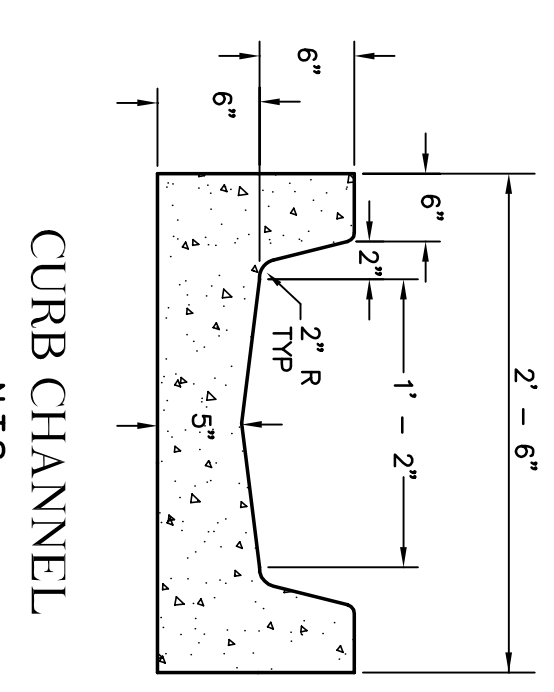

CURB CHANNEL

N.T.S.

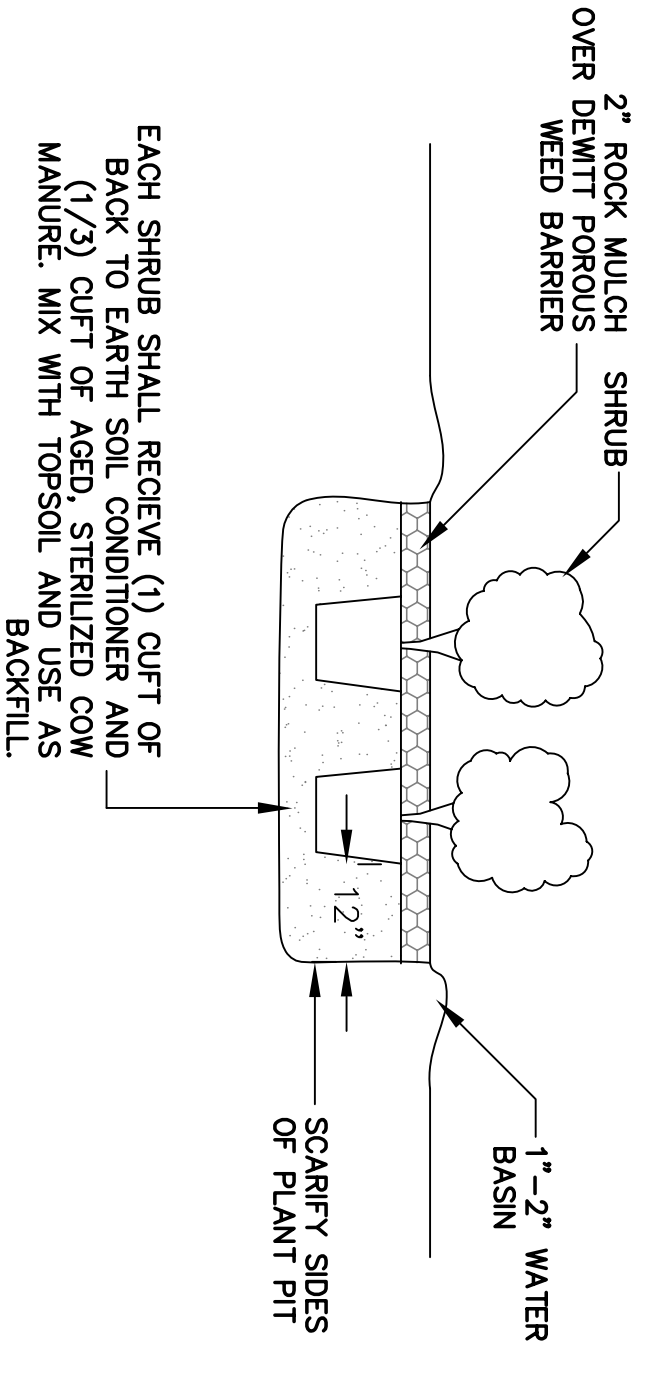

SHRUB DETAIL

N.T.S.

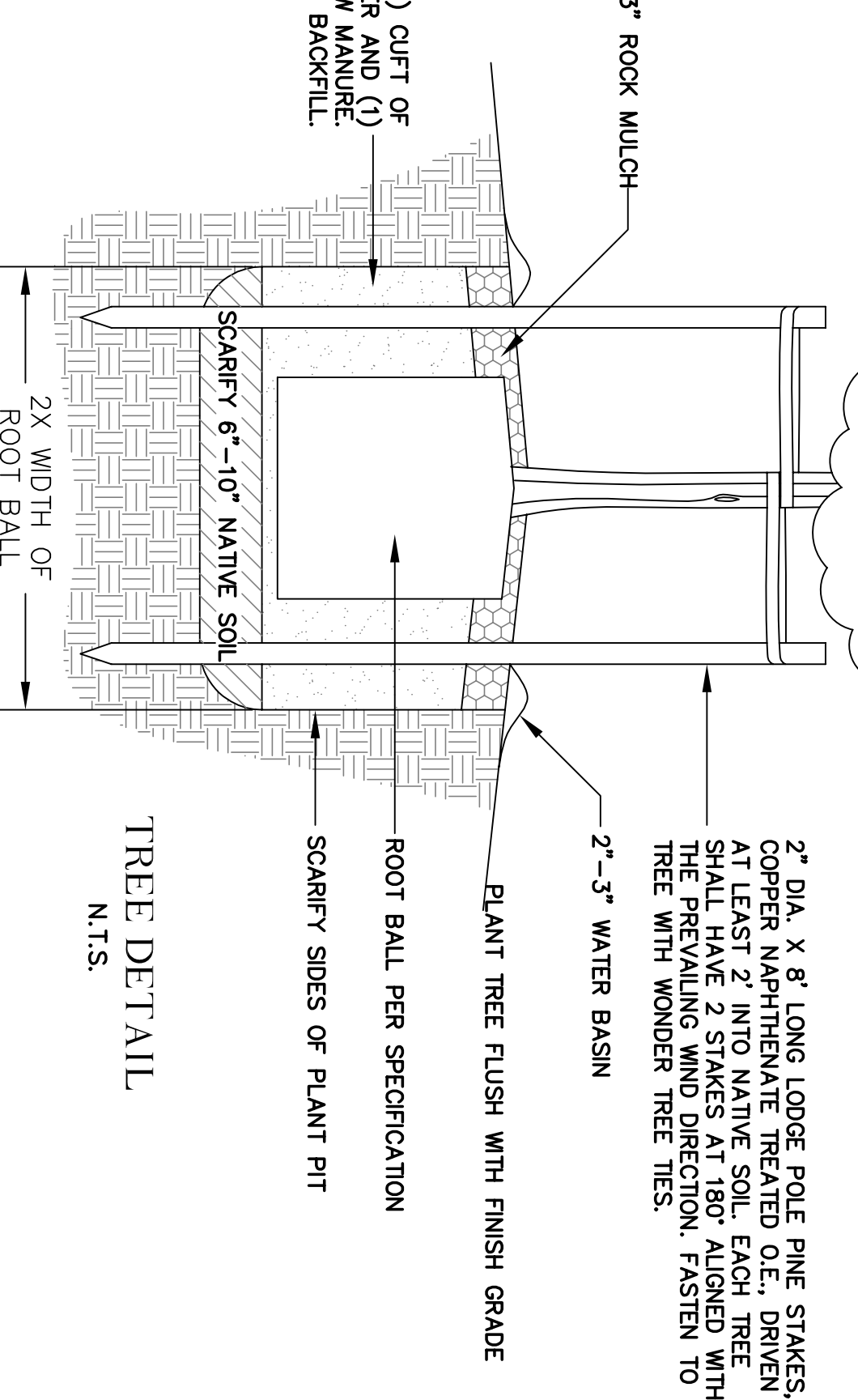

TREE DETAIL

N.T.S.

EL VALLE DE LOS RANCHOS
WATER & SANITATION DISTRICT
EL VALLE OFFICE BUILDING
Taos County, New Mexico

GENERAL NOTES & MISC. DETAILS

CHECKED: ARA DATE: JUNE, 2009 ENR'S FILE NO: 0825
DRAWN: ABH SCALE: NONE SHEET NO: 3